

## AREA 41

*Sandhills Strugglers*  
Ainsworth  
*Bassett Group*  
Bassett  
*Dam Bunch*  
Merritt Dam



## DIST. 14

*Sandhills Group*  
Theford  
*Mullen Group*  
Mullen  
*Sandhills Group*  
Valentine

# 3<sup>rd</sup> Annual Sober Float

Join District #14 for a weekend of fun, fellowship & floating down the Niobrara River  
(Nebraska's only National Scenic River) Near Valentine.



June 24, 25, & 26 2011



### June 24 (Friday)

6AM -?? coffee  
8PM campfire meeting

### June 25 (Saturday)

6AM-8:30AM coffee & breakfast  
9AM shuttle from Sharps to Berry Bridge for launch.  
12PM-3PM lunch at Sharps campground (1/2 way)  
(Dist.#14 will provide lunch.)  
3PM launch from Sharps to Rocky Ford.  
5PM-7PM return shuttle to Sharps.  
8PM-?? campfire meeting.  
?? - >> Live Music

### June 26 (Sunday)

6AM-?? coffee & breakfast



### River Fees

\$25 per person, 13 & under 1/2 price,  
preschool & under free. This includes shuttle  
from camp to launch, use of tube, canoe, kayak,  
landing & return shuttle to camp.  
\$7 shuttle, launch, land with your own personal  
river transportation.

### Camp Fees

\$10 electric hookup  
+ \$4 per person  
\$2 for 13 & under  
free for 5 & under  
per night.

Contact Sharps outfitters to reserve your space (402) 376-2506 (Riverside camping)  
**(You must mention Dist. #14 Sober Float to get these rates.)**

Questions or for more info contact:

Dan (308) 645-2423

Chris (402) 376-3882 home#

(402) 389-1444 cell#



**see map on back**

# CHERRY COUNTY

# SOUTH DAKOTA

# KEYAPA

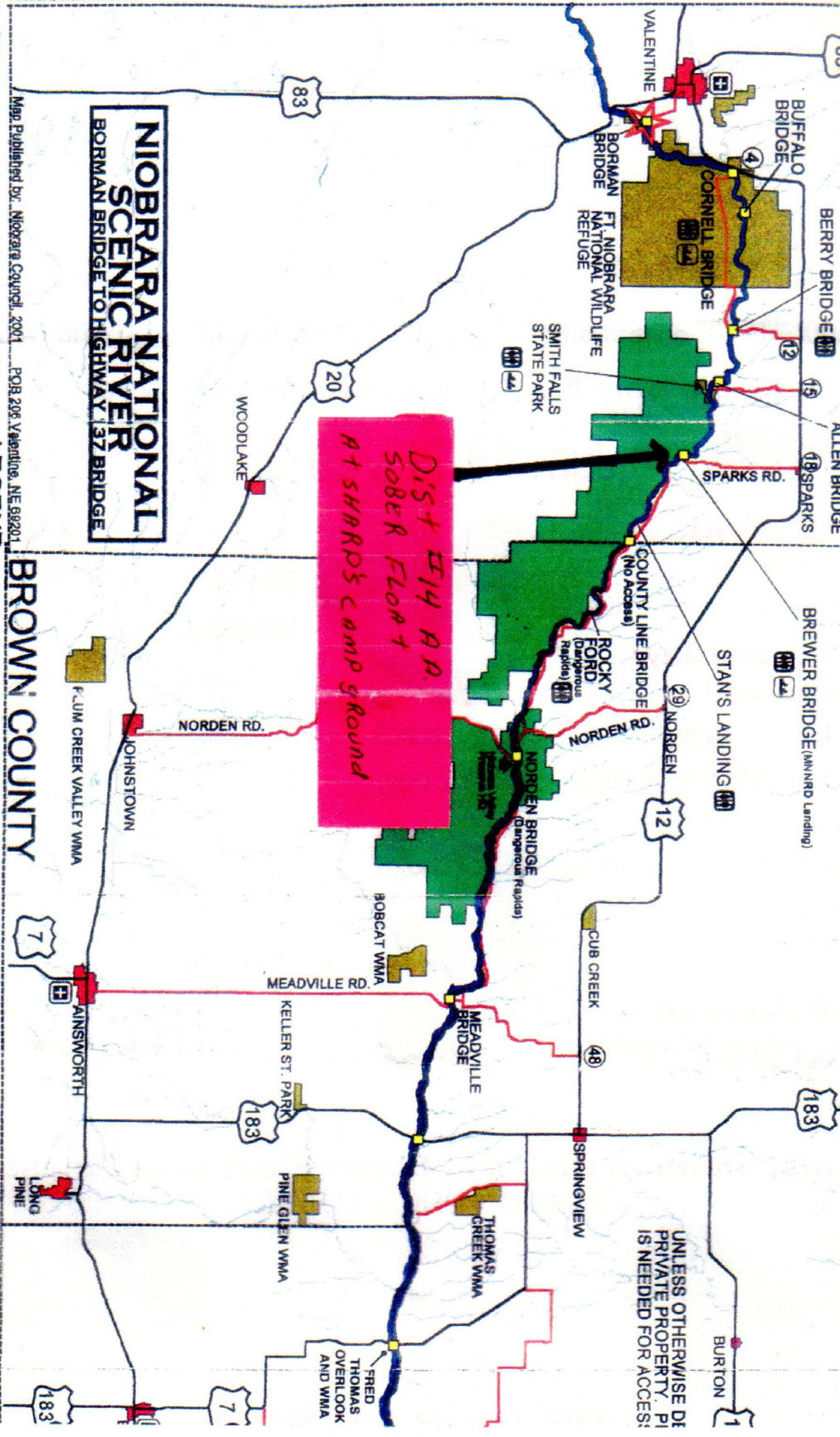

**NIORARA NATIONAL SCENIC RIVER**  
 BORMAN BRIDGE TO HIGHWAY 37 BRIDGE

*Dist #14 RR  
 Sober Flort  
 at Shards Camp Ground*

UNLESS OTHERWISE DE  
 PRIVATE PROPERTY. PI  
 IS NEEDED FOR ACCE:

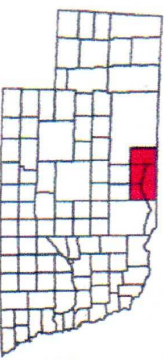

- LEGEND**
- Bridges
  - State Line
  - County Lines
  - Niobrara River
  - Streams

- Highways
- Access Roads
- Towns
- Public Use Lands
- Nature Conservancy Lands
- ★ Scenic River Designation

- ⑫ Mile Markers
- ⊕ Hospital
- ⊕ Public Landing/Launch
- ⊕ Public Restroom

- DISTANCES**
- MURDOCK
  - NEWPORT
  - NORTH PI
  - OMAHA, N

Map Published by: Niobrara Council, 2001  
 POB 206, Valentine, NE 68201

# BROWN COUNTY

10

This document was created with Win2PDF available at <http://www.win2pdf.com>.  
The unregistered version of Win2PDF is for evaluation or non-commercial use only.  
This page will not be added after purchasing Win2PDF.